

SAFETY FIRST

The Shroud kit features a flat-pack, lightweight, polycarbonate panel which is extremely tough and durable. When forming it around the beacon, as described below, it is essential to be aware of the hazards that the panel can present while under tension.

TOOLS REQUIRED

Tri-head key

INSTALLATION

1. Completely remove and retain the tri-head fixing from the top of the Modubel globe and remove the tri head fixings and retainer washers located on the gallery (DO NOT REMOVE THE SLOTTED SCREWS).
2. Take the shroud panel, texture side up, and position the central square clearance hole over the square projection at the crown of the Modubel globe.
3. Replace the tri-head fixing at the top of the globe, ensuring that the fibre washer is between the screw head and the square load washer.
4. Take the one end of the shroud panel and form it around the globe ensuring to meet the shroud to the gallery at the correct fixing point. Fix the shroud in place by re-inserting the tri-head screw, remembering to attach the plastic retainer washer between the shroud and the gallery fixing point.
5. Repeat step 4 on the opposite side of the shroud to complete the process.

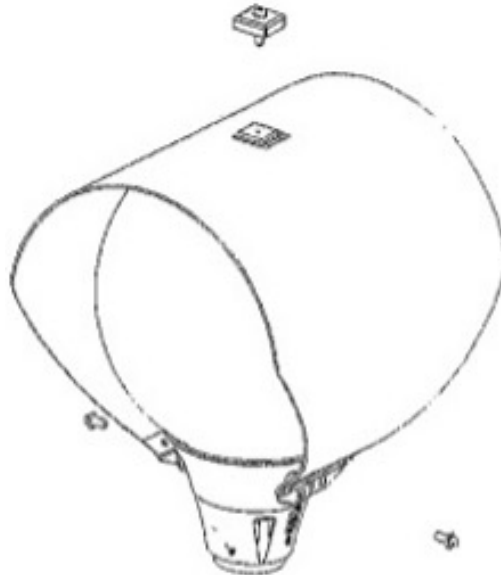

Simmons signs Limited reserves the right to alter or improve this guide without prior notice