



DESCRIPTION

The LU(M) is a high performance lighting system for motorway gantry signs, requiring very low levels of maintenance, with remote or built in drivers as required. It features a quick and easy alignment system making it ideal for both up lighting or down lighting motorway gantry signs.



BS EN 12899

CONSTRUCTION

Body

Cast LM6-M aluminium, acid cleaned, chromate primed and polyester powercoated. All threads are stainless steel bushed and all fasteners are retained.

Lighting

Pre-wired with LEDs mounted on a removable gear tray, with optically engineered lens system.

Lens

4mm toughened self-cleaning glass, fitted flush from the front. Incorporating quick access latches with optional locking.

Mounting

Polyester powder coated stainless steel 180 degree trunnion mount in 10 degree increments. Suitable for mounting both above or below the sign.

Maintenance

Quick release.

CONTROL/SWITCHING OPTIONS

The Motorway Road Lighting Control System (MoRLICS) compatible central management systems (CMS)

Photocell options

SELV remotely driven

PACKAGING

Product	Weight	Packing	Dimensions	Pack Quantity
LU(M)	12.7KG	Carton	42.5 x 30 x 28cm*	1

*Some Node versions will require deeper packaging TBA

Simmons signs Limited reserves the right to alter or improve this guide without prior notice.

LED		
Voltage	230V Mains	50V SELV Remote
Light Source	24 X 1W	24 X 1W
Power (W)	41W	41W
Warranty (yr)	6/12	6/12

6 year driver warranty, 12 year LED and body warranty.

Polar plots of 3 available optics

Luminous Flux OO Optic 3593lm

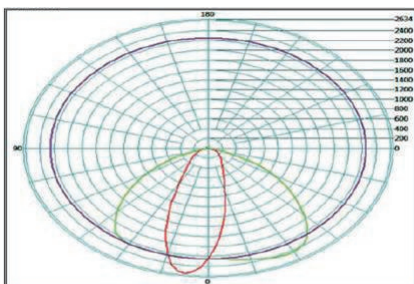

Luminous Flux OM Optic 3930lm

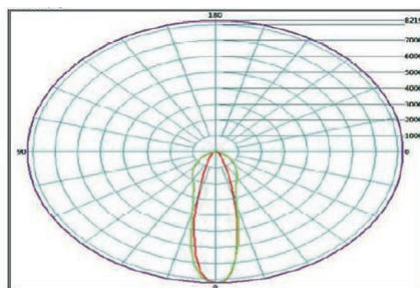

Luminous Flux WW Optic 3902lm

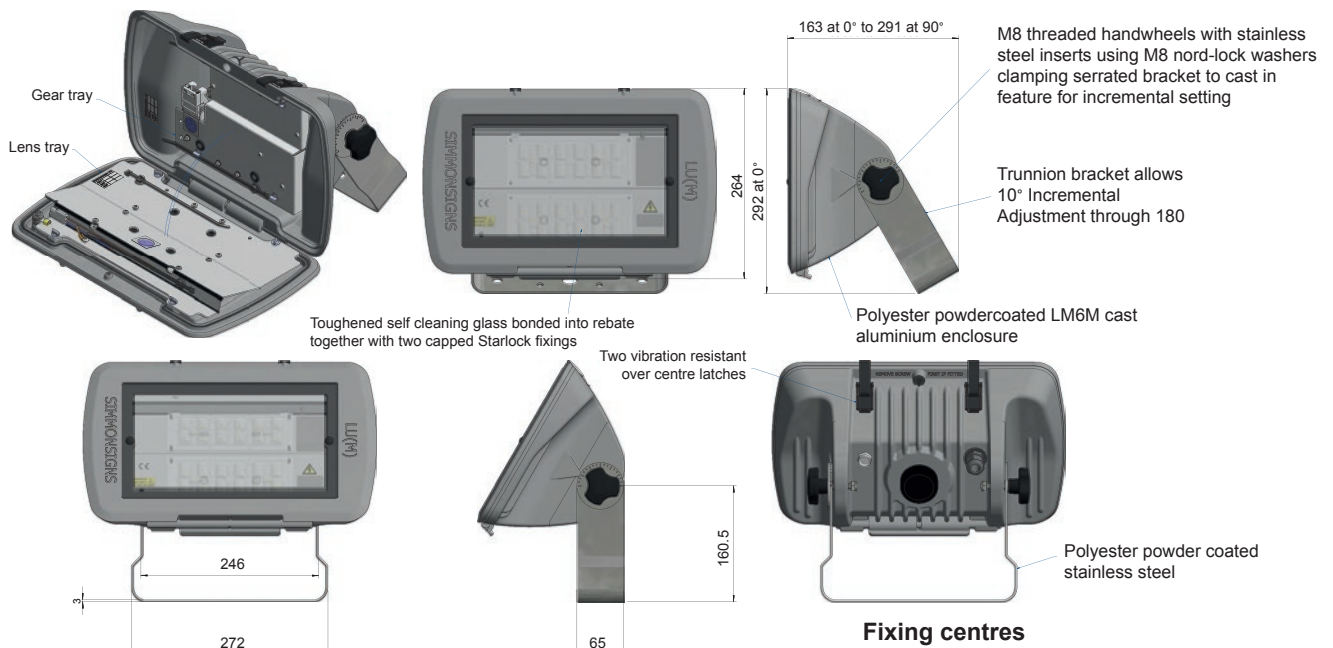
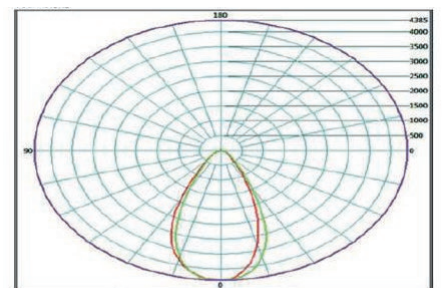

Simmons signs Limited reserves the right to alter or improve this guide without prior notice.