

SAFETY FIRST

Survey the site for buried services before commencing excavation.

Isolate the mains electrical supply before commencing installation.

All electrical work must be carried out in accordance with the latest IET wiring regulations (BS7671) by suitably qualified engineers.

Note: to provide protection against corrosion, the column base has a protective coating internally and externally to a height of 850mm. The base plate also has a protective coating. Care should be taken during installation to ensure that this coating is not compromised.

PACKING LIST

Box 1

- Column base (**Note: the base plate is packed in box 3**).
- Cast cone trim.

Box 2

- Illuminated section.

Box 3

- Beacon globe and light unit.
- Base plate.

TOOLS REQUIRED

- 19mm deep drive socket (supplied).
- ½" drive socket wrench.
- 5mm security Allen key (supplied).
- Tri-head key.
- 2 x 13mm combination spanners.
- Terminal screwdrivers.
- Concrete 'Gen 1' to BS 8500 or equivalent.

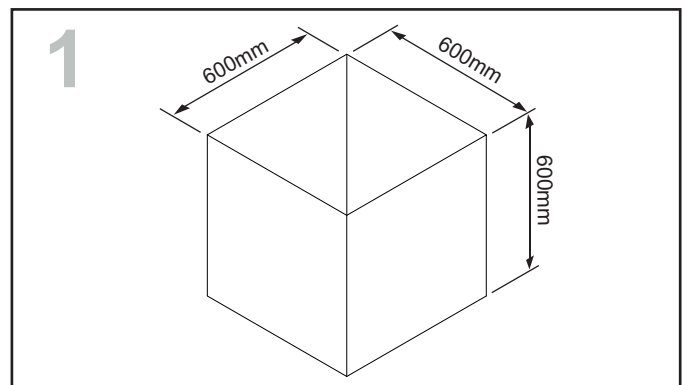

Excavate a hole 600 x 600 x 600mm deep.

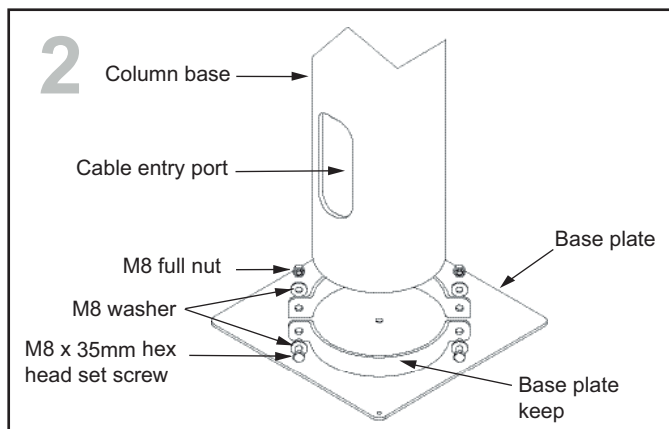

Unpack the column base and cast cone trim (see figure 4 for illustration) and set the cast cone trim aside for later.

See the note regarding the protective coating under SAFETY FIRST.

Attach the base plate using the base plate keep, M8 x 30mm hex head set screws and M8 full nuts and washers.

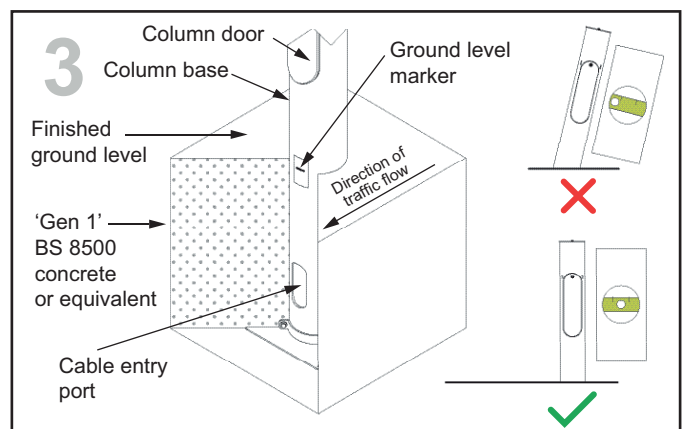

Insert the column base into the hole, making provision for the mains supply to enter the base through the cable entry port.

Note: the column base must be positioned in the centre of the hole with the column door facing away from oncoming traffic and the ground level markers on the base must be exactly in line with the finished ground level.

Backfill the hole with concrete ('Gen 1' to BS 8500 or equivalent), up to the ground level markers on the column base, using a spirit level to ensure that it is vertical.

Note: allow the concrete to set before continuing with the installation.

Simmons signs Limited reserves the right to alter or improve this guide without prior notice.

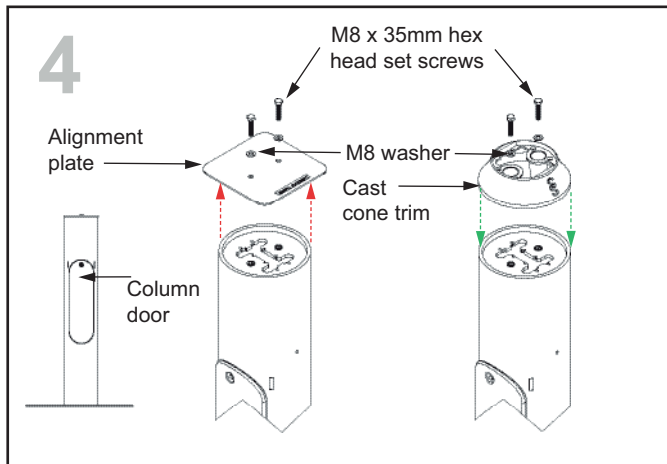

Once the concrete has set, remove the alignment plate from the column base and re-use the M8 x 35mm hex head sets and washers to fit the cast cone trim.

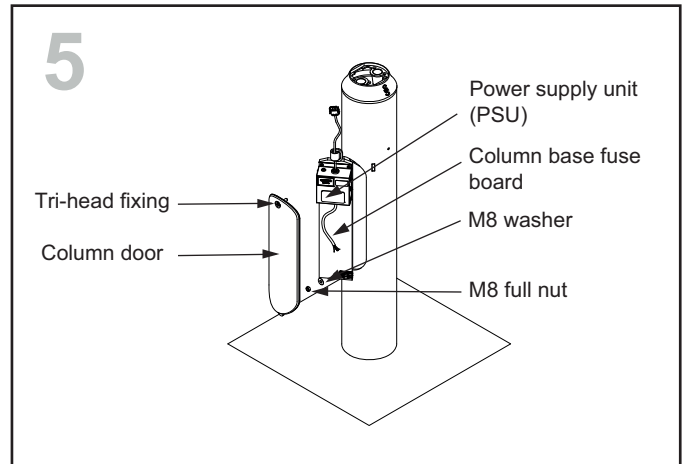

Remove the column door by loosening the Tri-head fixing.

Remove the column base fuse board by undoing and retaining the M8 full nut and washer at the bottom, lifting the bottom of the board off the stud, then lowering it and with a twisting motion lifting it out through the door aperture.

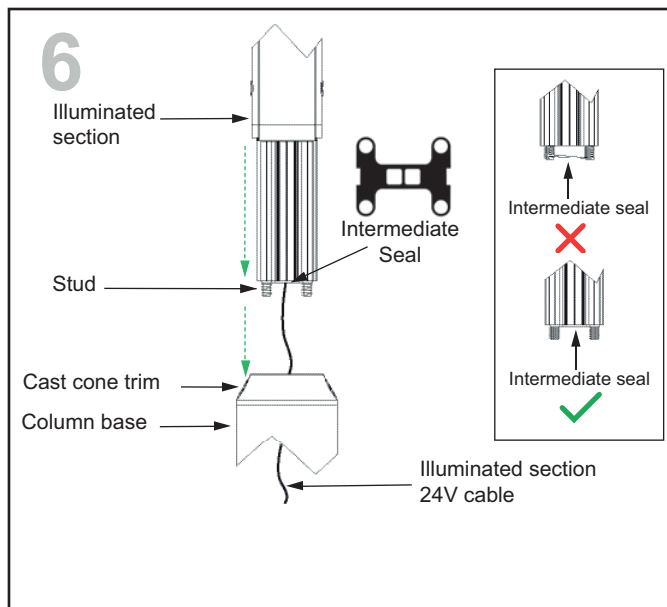

Unpack the illuminated section, removing and retaining the 4 x M12 Nyloc nuts and washers fitted to the studs located on the base.

Check that the intermediate seal is correctly in place.

Pass the 24V cable which exits the bottom of the illuminated section, through the top of the cast cone trim and down into the column base.

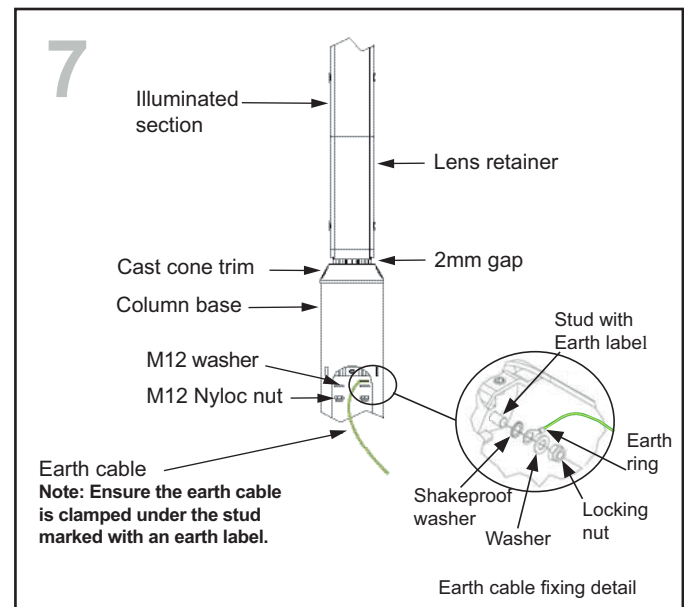

Insert the four studs at the base of the illuminated section into the holes at the top of the column base.

From inside the column base, refit the 4 x M12 Nyloc nuts and washers to the illuminated section studs. The 12mm ring on the end of the free earth wire is secured under the nut of the stud marked with an earth label. Ensure that a shakeproof washer is fitted between the earth ring and the bare metal face (see diagram).

Note: ensure the illuminated section is firmly seated. As a guide there should be a 2mm gap between the bottom of the lens retainer and the top of the cast cone trim.

Simmons signs Limited reserves the right to alter or improve this guide without prior notice.

8

Refit the column base board.

Slide the board (lower end first) into the door aperture with a twisting motion. Hook the pointed end of the board under the tang in the upper end of the column base section. Refit the M8 washer and M8 full nut.

Note: ensure that the board is secure.

Connect the illuminated section cable plug to its corresponding in-line socket on the PSU.

Connect the isolated mains supply cable to the PSU, in accordance with IET regulations. An area is provided on the base board for securing any termination equipment that may be required.

9

Locate the 2 x M6 cheese head set screws on the beacon support mast, remove the upper one and keep it safe.

Slide the beacon light unit over the support mast so the cut-out in the circuit board slides over the lower M6 cheese head set screw, thus ensuring the holes line up and allowing the upper M8 cheese head set screw to be re-inserted.

Insert the three pin connector from the flasher circuit board into the three pin socket marked "Beacon" on the small connector board.

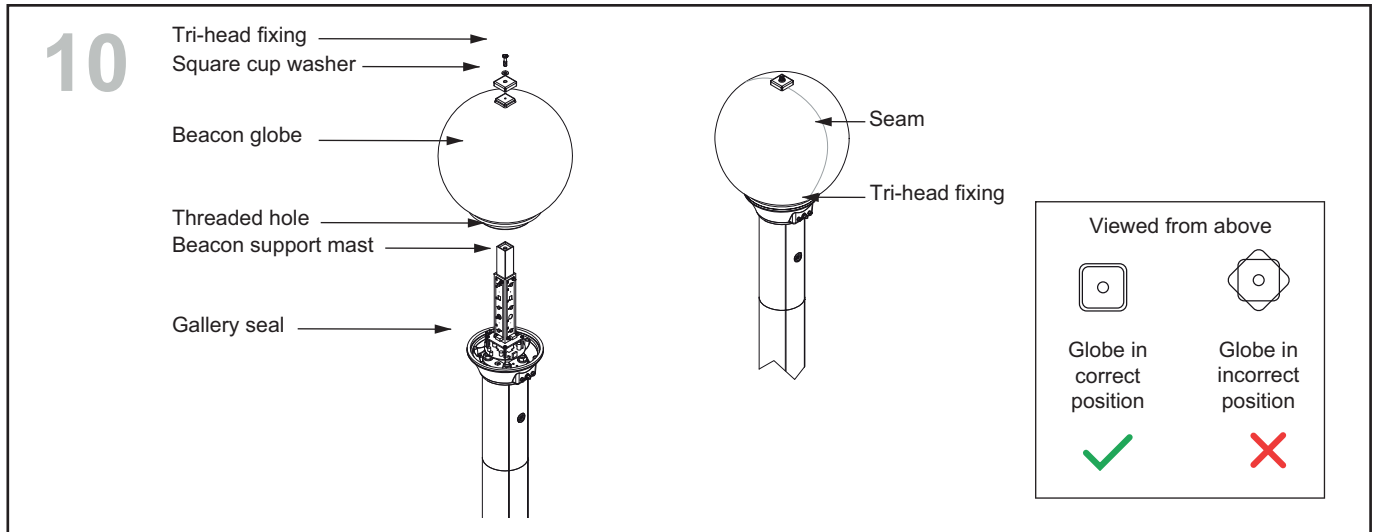

Place the beacon globe onto the gallery so the beacon support mast engages in the square recess in the top of the globe and the seam in the beacon lines up with the Tri-head fixings on the gallery. It may be necessary to rotate the globe slightly.

Note: check the globe sits evenly on the gallery seal.

Tighten the Tri-head fixing which passes through a square cup washer at the top of the globe and into the threaded hole in the top of the beacon support mast.

Reconnect the mains power supply in accordance with IET regulations. Check the operation of the illuminated stem and beacon. Refit the column door.

Simmons signs Limited reserves the right to alter or improve this guide without prior notice.